



Installation & Application Data

- 1) Before installing, be sure the valve hasn't been damaged in transit.
- 2) Use clean air filtered to $40\mu\text{m}$. Be aware of the flow direction & port size.
- 3) Please note whether the installation conditions meet the technical requirements (such as actuation frequency, working pressure & temperature before installing the valve.
- 4) Notice the flow direction of air during installation, P is the air input, A (B) is the outlet port and R (S) is the exhaust port.
- 5) Avoid freezing temperature and vibration.
- 6) Before using fittings and tube make sure they are clean.

MANUAL 3/2 WAY VALVES CKL



Specification

Model	CKL110-06	CKL210-08	CKL310-10
Fluid	Air (to be filtered by 40µm filter element)		
Operating	Manual control direct acting type		
Port ①	1/8"	1/4"	3/8"
Orifice	12.0mm ² (Cv=0.67)	16.0mm ² (Cv=0.89)	30.0mm ² (Cv=1.67)
Valve Type	3/2		
Lubrication ②	Not required		
Pressure Range	0 - 0.8MPa (21 - 114psi)		
Proof Pressure	1.5 MPa (215psi)		
Temperature	-20 to +70°C		
Material of Body	Aluminum Alloy		



① PT thread, NPT thread and G thread are available;

② If add oil for lubrication, it is not allowed to stop midway. It is suggested to use ISO VG32 lubricant or the oil with the same grade.

Ordering Codes

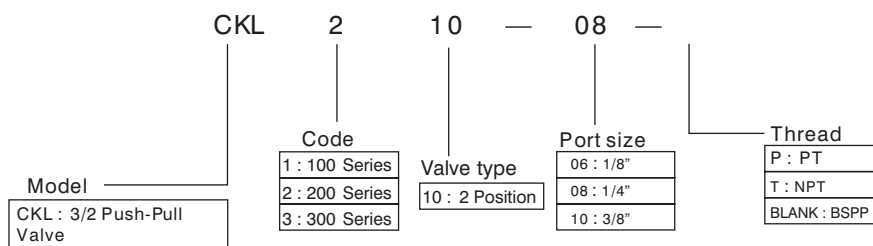

Symbol

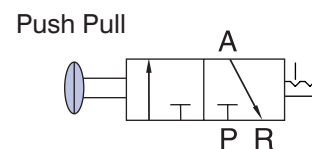

Flow Charts

Model: CKL110-06

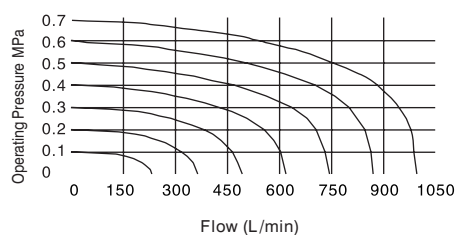

Model: CKL210-08

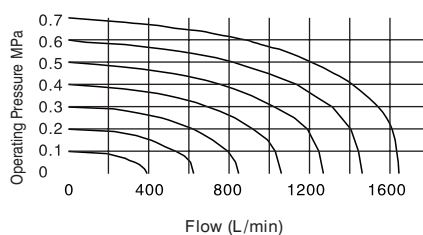

Model: CKL310-10

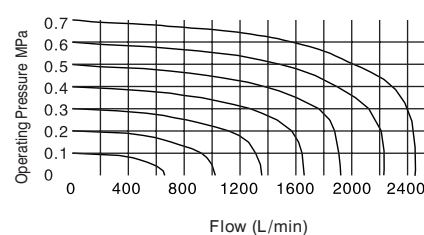

MANUAL 3/2 WAY VALVES CKL



Dimensions

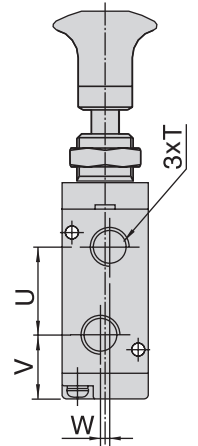
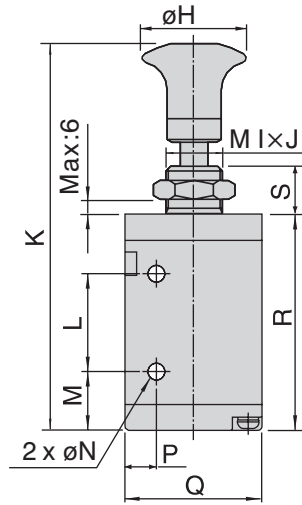
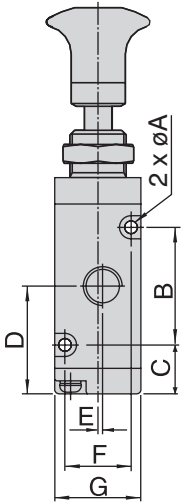

Model	CKL110	CKL210	CKL310	Model	CKL110	CKL210	CKL310
	06	08	10		06	08	10
A	3.3	3.3	4.3	L	21	25	30
B	19	30	35	M	12.2	15.2	17.5
C	13.2	12.7	15	N	3.3	4.3	4.3
D	23.7	27.7	32.5	P	7.5	8	10
E	1	1.5	2	Q	27	35	40
F	13	17	20	R	47	57	65.8
G	18	22	27	S	10	10	10
H	22	22	25	T	1/8"	1/4"	3/8"
I	12	14	16	U	16	22.5	24
J	1.0	1.0	1.0	V	14.7	16.5	20.5
K	79	90	100	W	2	0	0

Inner Structure

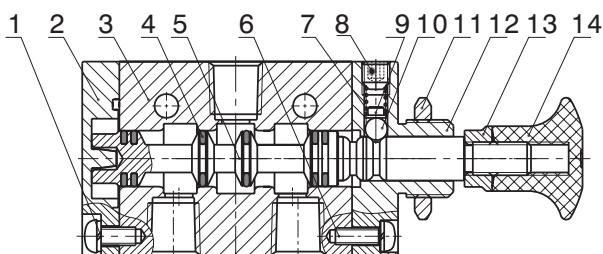

No.	Item	No.	Item	No.	Item	No.	Item
1	Round Head Screw	5	Spool	9	Spring Base	13	Safety Nut
2	End Cover	6	Round Head Screw	10	Steel Ball	14	Knob
3	Body	7	Spring	11	Hexagon Nut		
4	O-ring	8	Stop Screw	12	End Cover		