

**NEW**

**PNEUMATIC COUPLINGS**  
PNEUMATISCHE KUPPLUNGEN

**SERIE 022S.06**

SAFETY COUPLING WITH PUSH BUTTON  
SICHERHEITSKUPPLUNG MIT DRUCKKNOPF



**Couplers and Plugs**  
Kupplungen und Nippel

Connection  
Anschlüsse

Order No  
Bestellnr.

SW

L

ØD

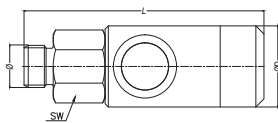

Male Thread Coupling  
Kupplung mit Aussengewinde

|          |               |    |      |    |
|----------|---------------|----|------|----|
| BSP 1/4" | 022.S06 EG 13 | 20 | 67.7 | 25 |
| BSP 3/8" | 022.S06 EG 17 | 20 | 70.7 | 25 |
| BSP 1/2" | 022.S06 EG 21 | 24 | 70.7 | 25 |

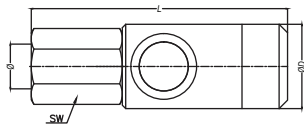

Female Thread Coupling  
Kupplung mit Innengewinde

|          |               |    |      |    |
|----------|---------------|----|------|----|
| BSP 1/4" | 022.S06 DG 13 | 20 | 69.7 | 25 |
| BSP 3/8" | 022.S06 DG 17 | 20 | 71.7 | 25 |
| BSP 1/2" | 022.S06 DG 21 | 24 | 75.7 | 25 |

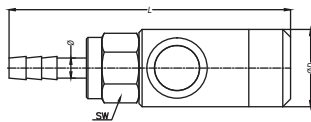

Standard Hose Barb Coupling  
Kupplung mit Schlauchtülle

|             |               |    |      |    |
|-------------|---------------|----|------|----|
| Ø 6 - 1/4"  | 022.S06 HG 06 | 20 | 84.7 | 25 |
| Ø 8 - 5/16" | 022.S06 HG 08 | 20 | 84.7 | 25 |
| Ø 10 - 3/8" | 022.S06 HG 10 | 20 | 84.7 | 25 |

**Interchangeability - Kompatibilität**

TST 014 & 022, ARO 210, RECTUS 14 & 22, Industrial Interchange 1/4", Orion 44510, CEJN 300, JWL 522 & 532, DynaQuip DM-2, Aerequip FD41, Gromelle G-16600

**Temperature Range - Temperaturbereich**

-20°C +100°C (-4°F +212°F)

**Working Pressure - Betriebsdruck**

0 - 12 bar (0 - 508 PSI)

**Flow capacity - Nennweite**

NW - 5,5

For optional orders please add the symbol of your option end of the order no.  
Bei Bestellungen Kennbuchstabe bitte hinzufügen.

**Material -Material**

|                          |  |
|--------------------------|--|
| Inner Part - Innenteil   | : Aluminium - Eloxal - Aluminium - Eloxal                                |
| Back Part - Verschluss   | : Brass Nickel Plated - Messing Vernickelt                               |
| Valve - Ventil           | : Steel Chrome Plated - Stahl Verchromt                                  |
| Spring - Feder           | : Stainless Steel - Edelstahl  |
| Coupler Body - Gehäuse   | : Steel Chrome Plated - Stahl Verchromt                                  |
| Seals - Dichtungen       | : Nitrile (Ni) - NBR   |
| Balls - Kugeln           | : AISI 420 Hardened - Edelstahl AISI 420                                 |
| Push Button - Druckknopf | : AISI 420 Hardened Steel - Chrome Plated - Edelstahl AISI 420 Verchromt |